

STRIMMER BRUSH CUTTER PETROL

USAGE

The machine is solely intended for cutting long grass, weeds and light undergrowth.

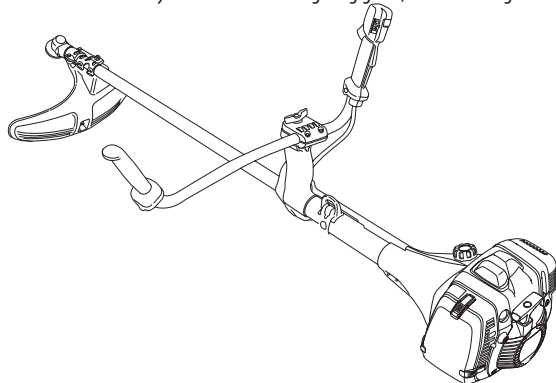

PARTS OVERVIEW

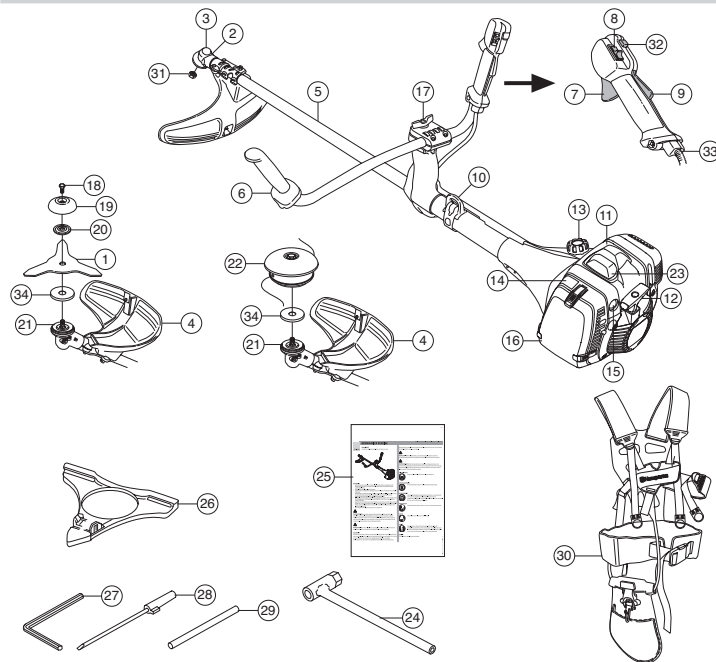

- | | |
|-------------------------------------|------------------------------|
| 1 Strimmer blade | 18 Locking screw |
| 2 Refill lubricant | 19 Support head |
| 3 Angular transmission | 20 Support flange |
| 4 Protective guard for cutting tool | 21 Pick up |
| 5 Shaft | 22 Trimmer head |
| 6 Handle | 23 Sparkplug and cap |
| 7 Throttle lever | 24 Blade nut wrench |
| 8 Stop switch | 25 Instruction manual |
| 9 Throttle lock | 26 Transportation protection |
| 10 Bracket for carrier set | 27 Allen wrench |
| 11 Cylinder protective cap | 28 Carburetor screwdriver |
| 12 Starter lever | 29 Locking pin |
| 13 Fuel tank | 30 Carrying strap |
| 14 Choke lever | 31 Lock nut |
| 15 Fuel pump | 32 Start throttle button |
| 16 Air filter cover | 33 Adjustable throttle cable |
| 17 Handlebar adjustment | 34 Washer |

IMPORTANT!

- Always wear personal safety equipment.
- Users of the machine must ensure that no people or animals come closer than 15 meters to the machine when operating. If multiple users work in the same workplace, the safety distance must be at least double the boom length, but always a minimum of 15 meters.
- Execute a general inspection of the machine before using it.

IMPORTANT!

A Strimmer Brush Cutter may be a dangerous tool when used improperly or without due care and may cause serious or fatal injury for the user or others. It is essential that you read and understand the contents of this manual.

When using the machine, approved personal protective equipment must be used. Personal protective equipment does not eliminate the risks, but reduces the harmful effect in case of an accident.



CAUTION! Machines that are equipped with saw blades or blades for grass cutting can exert tremendous side way force when the blades come into contact with a solid object. This is called a backlash. Always keep people and animals at least 15 meters from the machine.

Throttle lock

The throttle lock is designed to prevent accidental throttle activation. When latch (A) is pressed into the handlebar (= when holding the handlebar), the throttle lever is disengaged (B). When the handle is released, both throttle lever and throttle lock return to their respective starting positions. This occurs via two independent spring return systems. This position means that the throttle lever is automatically locked to idling setting.

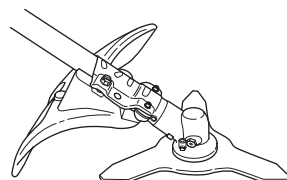
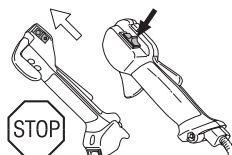
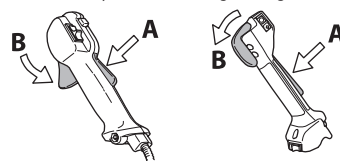

Stop switch.

The stop switch must be used to turn off the engine.

Start the engine and check that the engine switches off when the stop switch is turned to the stop position.

Protective guard for cutting tool.

The protective guard prevents loose objects from being thrown in the direction of the user. The protective guard also prevents the user from coming into contact with the cutting tools.

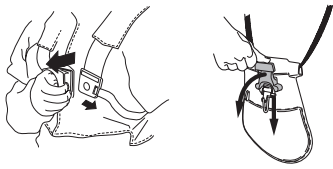

Quick release.

At the front is an easily accessible quick release as a safety measure if the engine catches a flame or in another situation where one has to get rid of the machine and the carrier quickly. See instructions in the section Adjusting the carrier strap and the Strimmer. On some carriers, there is also a quick release on the suspension hook.

Check that the straps of the belts are fitted correctly. When the carrier straps and the machine have been adjusted, you need to check that the carrier quick release is working.

Lock nut

Lock nuts are used for securing a particular type of cutting equipment.

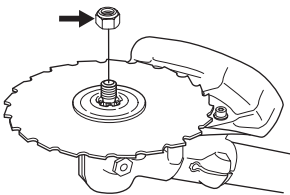

When assembling, rotate the nut against the rotation direction of the cutting equipment. To remove, turn the nut in the rotational direction of the cutting equipment.

Caution! The nut has an anti-clock wise thread!

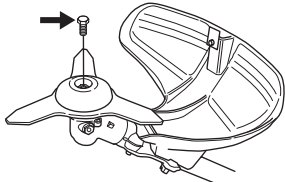

Lock screw

In case of a carrier plate with ball bearings, the locking screw must be tightened.

1. ASSEMBLY

Adjusting the carrier strap of the strimmer.

When operating the strimmer, it must always be hooked up to the carrying belt. Otherwise, you will not be able to operate the Strimmer in a safe manner and possibly injure yourself and others. Never use the carrying belt with a defective quick release device.

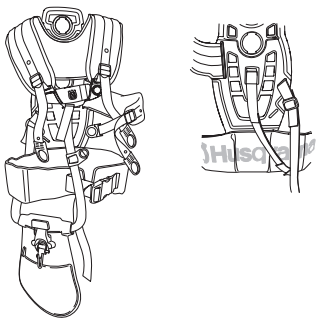

Balance XT

The correct balance

For cutting grass and undergrowth: Allow the blade to balance at the appropriate cutting height. i.e. close to the ground.



2. FUEL MANAGEMENT

Fuel

Note! Always use Aspen 2T fuel from the rental center.

Refuelling



CAUTION! To reduce the risk of fire, always take the following precautions:

Always refuel outdoors, away from sparks or flames.

Do not smoke or place hot objects near the fuel.

Never refuel while the engine is running. Stop the engine and allow it to cool for a few minutes before refuelling. Carefully open the tank cap when you want to refuel so that any over-pressure slowly disappears.

Thoroughly tighten the cap of the tank after refuelling.

Do not start the engine in the vicinity of the fuelling area

3. STARTING AND STOPPING

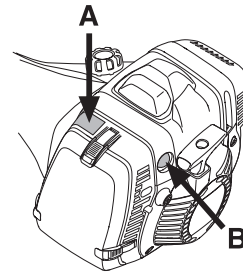

Cold engine

Choke: Place the choke lever (A) in the choke position. **Fuel pump:** Squeeze the rubber bellows (B) of the fuel pump several times until fuel flows into the bellows. The bellows do not have to be completely filled.

Warm engine

Follow the same starting procedure as for the cold engine, but without the choke engaged.

Starting :

Starting throttle mode is achieved by pressing the throttle lever and throttle first and then pressing the start throttle button (A). Then release the throttle lock and throttle lever and then the start throttle button. The start throttle function is now activated. To return the engine to stationary walking, press throttle lever and throttle lever.

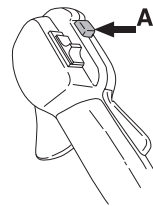

Starting



CAUTION! When the engine is started with the choke lever in the choke or start gas position, the cutting tool begins to rotate immediately. Press the machine body with your left hand against the ground (**NOTE!** Not with your foot!). Hold the start lever, pull the starter cord slowly with your right hand until you feel resistance (the engage mode hooks in) and then make rapid and powerful pulls. Never wrap the starter cord around your hand.

Set the choke lever immediately after the engine is firing back and reset start attempts until the engine starts. When the engine starts, give full throttle and the starter throttle will turn off automatically.

NOTE! Do not pull the starter cord fully out and do not let go of the start lever when it is fully extended. This can cause damage to the machine.

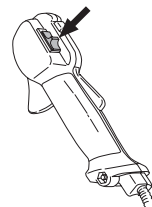

Stopping

Stop the engine by switching off the ignition.



CAUTION! Beware of objects slung out. Never bend over the cutter's protective guard. Stones and dirt etc. can be thrown up into your eyes causing serious injury or blindness. Children, animals, spectators and employees must remain outside the 15 m safety area. Turn off the machine immediately if someone gets closer. Never swing the machine around without first checking that there is no one in the safety zone behind you.



CAUTION! Machines that are equipped with saw blades or blades for grass cutting can exert tremendous side way force when the blades come into contact with a solid object. This is called a backlash. A backlash can be so violent that the machine and / or operator are pushed into one direction and may lose control over the machine. A backlash can occur without advance warning when the machine gets hooked, locked or jammed. The chance of backlash is greater in areas where it is difficult to see what you are cutting.

Try not to operate in an area between 12 and 3 hours of the cutting tool. Due to the rotational speed of the blade, a backlash can occur precisely within this area when cutting into coarser wood stems.

- Always use the correct equipment.
- Make sure the equipment is always properly adjusted and correctly installed.
- Follow the safety precautions.
- Organise the work.
- Make sure the blade runs at full speed before you begin work.
- Always use good sharp blades.
- Try not to cut into stones.
- Control the direction of work (make use of the wind).
- Before you start cutting, check the area of work: the condition of the terrain, whether it is slopes, are there any stones, or holes etc.
- Then start at the easiest end of the work area to get a good opening for the cutting work.
- Work systematically, back and forth, across the area and cover an area of approx. 4-5 m. Then the full range of the machine is used on both sides and the user gets an easy and varied field to work in.
- The length of the path must be about 75 m. Move the fuel storage tanks along as the work progresses.
- On sloping terrain, you should refrain from walking the paths perpendicular to the slope. It's a lot easier to walk across a slope than up and down.
- The paths should run in such a manner that you do not need to cross ditches or other obstacles in the terrain. Adjust the paths to the wind conditions so that the cut grass and undergrowth fall into in the already cleared area.

Contact your rental company should you encounter problems with the machine!
The product must be returned clean and undamaged.