

## CONCRETE MIXER

### Instructions for safety and use.

The concrete mixer is intended for mixing concrete. The large filler opening and conical shape of the tub enables rapid filling and emptying.

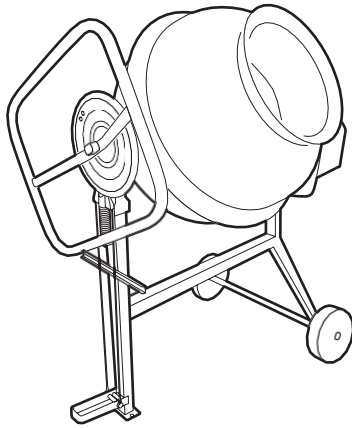

### Switching on and off make sure

- All the safety devices of the mixer are fitted and are mounted in accordance with the regulations.
- The on / off switch is located below the engine housing. Turn the motor **on and off solely by using the switch**.
- In case of a power failure, the machine turns off **automatically**. To restart, operate the switch again.

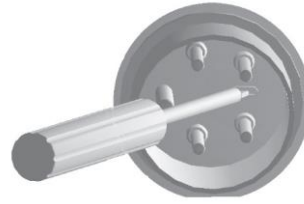

## 2. MIXING

### Concrete mixer

Swivel lever

Handwheel

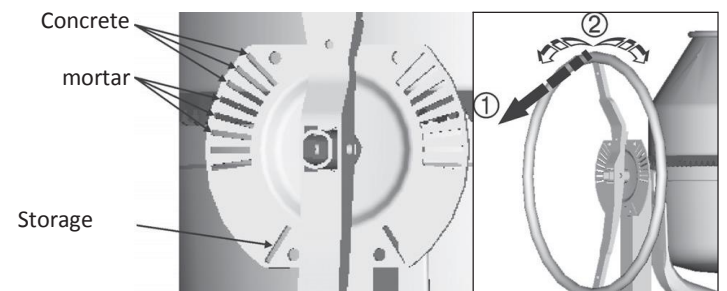

### Hold handwheel tight when pivoting.

1. Release the swivel assembly
2. Swivel the mixing drum into position according to your mix.
3. Allow the swivel to lock secure.

### Concrete mixer with brake

### Hold handwheel tight when pivoting.

1. Press on the brake pedal
2. Swing the mixing drum to the mark corresponding with the concrete mix.

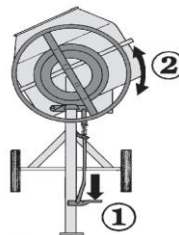

3. Release the brake pedal.

### Additional safety instructions

- **Fill and empty** the mixing drum only with the motor running.
- **Check the stability** of the mixer.

### Emptying the mixing drum: Hold the swing lever or hand wheel securely.

1. Unlock the swivel or operate the brake pedal
2. Tip the mixing drum slowly

## SAFETY INSTRUCTIONS



### Check before use

- Machine may not be switched ON, press red OFF button.
- Power Supply: Do not use any additional connections.
- Surface, must be flat and solid.
- Operation of locking mixing drum.
- Machine visually for damage.
- Plugs and connection cable for damage.

**Contact the rental company should you encounter any problems with the machine!**

### Safety during use

- Provide a clean, tidy workplace.
- Only add clean water.
- Never grab in a rotating mixing drum.
- Prevent overheating of motor. Keep air and discharge openings of the motor compartment free.
- Handle male/female plugs and connecting cable carefully.
- Never use machine with damaged plugs and / or connection cable.
- Use extension cable. Prevent voltage loss, use a minimum cable thickness of 2.5mm and keep the extension cable as short as possible. Unroll the cable all the way.

### Safety after operating

- After use, remove the plug from the power socket.
- After use, store the machine in a safe area.

## 1. OPERATING

Observe all safety instructions.

### Setting up the machine:

- Place the machine on a solid level **surface**.
- Avoid the machine from **sinking** into the ground. Accident prevention regulations (danger of tilting).
- Ensure when **placing** the machine that emptying it is unobstructed.

## 3. CLEANING

### Instructions for cleaning

- For a longer work **break** or when work has finished, clean the concrete mixer both the inside and the outside.
- Do not use **hard objects such** as a hammer or a shovel etc. to clean the mixing drum. A mixing drum with dents obstructs the mixing process and can be difficult to clean.
- For **cleaning** the inside of the drum insert some pebbles and use water whilst letting the drum rotate.
- **Concrete and mortar residues** attached to the teeth of the drive sprocket and girdle segments should be removed immediately.

**Contact your rental company should you encounter problems with the machine! The product must be returned clean and undamaged.**